

LEDNOVA

ROBUST AND HIGHLY RELIABLE
LED BULKHEAD



SUPERIOR EFFICACY

HIGH RELIABILITY

ROBUST

LOW MAINTENANCE

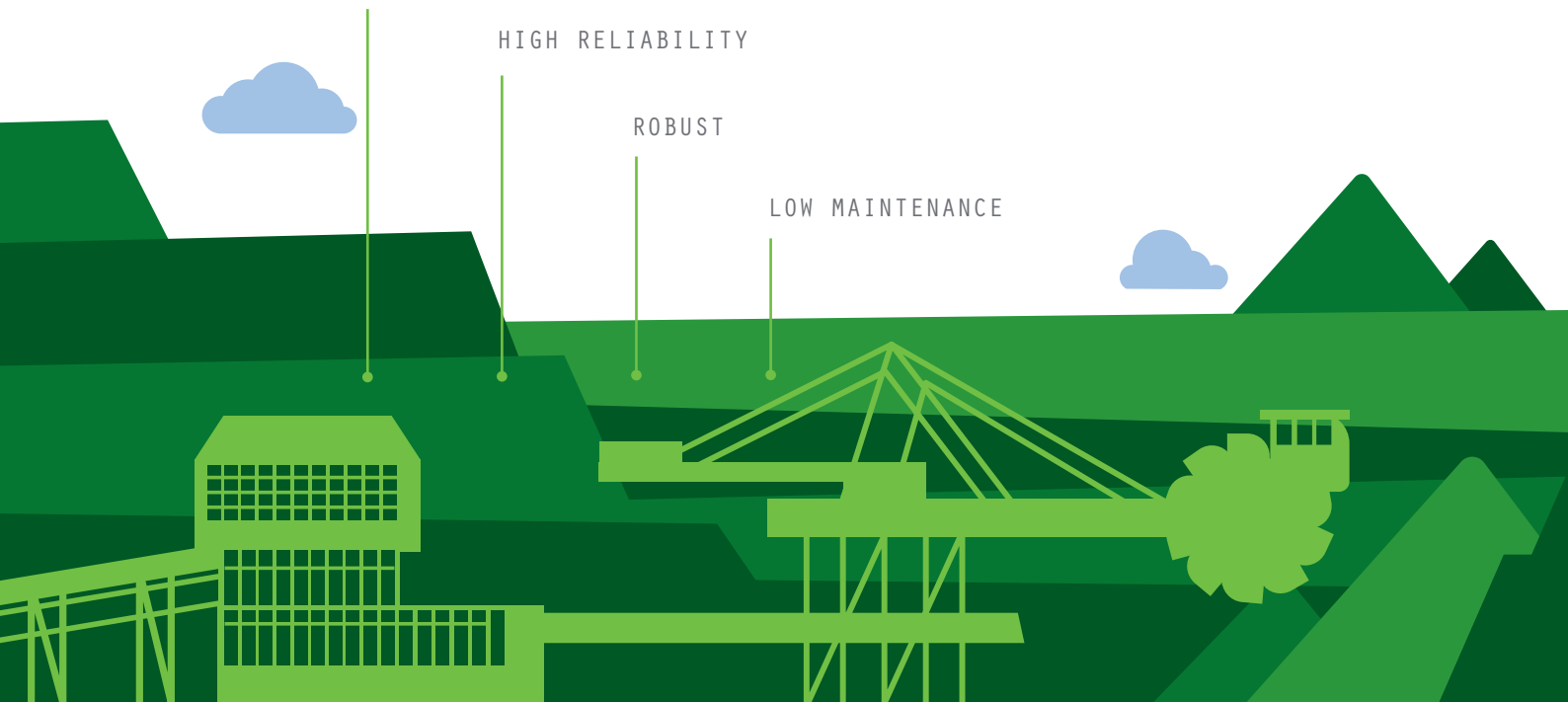

BEKA Schröder
Experts in lightability™

LEDNOVA



A ROBUST AND VERSATILE LED BULKHEAD

The LEDnova offers optimal photometric performance and high reliability to reduce energy consumption and maintenance in all types of lighting applications.

The LEDnova range is suitable for use in various environments, which include outdoor mining areas, oil and gas refineries, food and beverage plants, manufacturing process plants and any application that requires robust and well-built luminaires. Indeed, the LEDnova range has been developed to reduce disability glare and thus improve the quality of light.

A number of configurations are possible with this LED bulkhead, which include the standard surface mount version, the optional pole mount version, and the flood version. This makes it truly versatile!

The LEDnova range can also be used in hazardous environments where a Zone 2, 21/22 rated luminaire is required. It is also available with a battery backup version, to be used in emergency situations.

MAIN APPLICATIONS

LOADING BAYS



CONVEYOR BELT

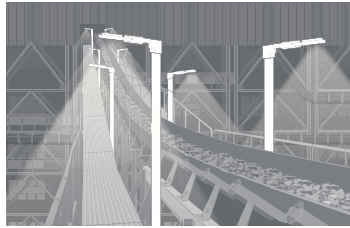

RECLAIMERS



OTHER ENVIRONMENTS WHERE LEDNOVA OFFERS
KEY CUSTOMER BENEFITS



TRANSPORT FACILITIES



INDUSTRIAL PLANT



RETAIL FACILITIES



RECREATIONAL FACILITIES

CONSTRUCTION DETAILS

The LEDnova's slim and unique design is optimising the thermal operating environment around the LEDs enabling the long useful lifetime (100 000hrs, L70) and low maintenance.

The luminaire housing is manufactured of corrosion-resistant aluminium (EN 1706 AC-44300).

Electronic temperature monitoring prevents overheating of LEDs and power supply within the LED compartment (ThermiX®). To maximize the reliability of the LEDs, the photometric engine and control gear compartment are completely sealed to IP 66. This ensures that the photometric performance is maintained over time.

The LEDnova offers flexible combinations of LED arrays, combined with various photometric distributions (LensoFlex®2) and dimming control options to further maximise energy savings and reduce maintenance costs.

It is designed for LED light sources between 20W and 81W.

The luminaire is power factor corrected to $\geq 0,95$.

KEY FEATURES

Corrosion-resistant
(EN 1706 AC-44300)
high-pressure die-cast
aluminium housing

Surge protection
10kV/10kA
Optional:
20kV/20kA (Midi only)

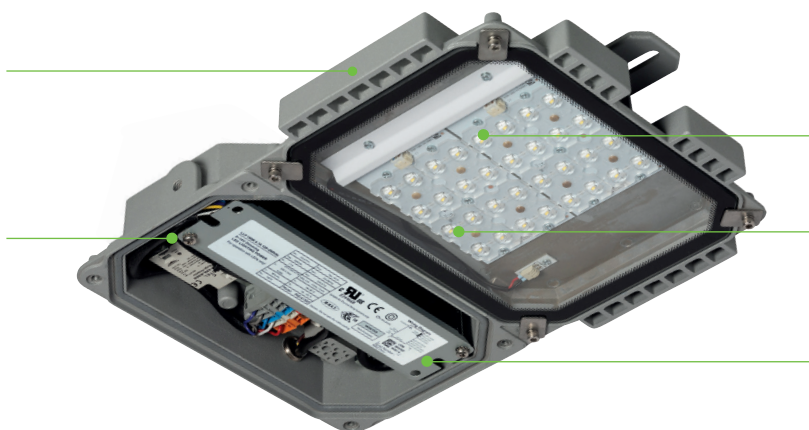

ThermiX®:
Maintains performance
over time

Optimised lighting
through LensoFlex®2

FutureProof:
Direct access to
photometric engine and
electronic assembly in
case of upgrading or
replacing components



LEDnova-mini



LEDnova-midi

- › Designed to operate LED light sources of up to 81W **without reducing the useful lifetime of up to 100 000 hours**, at a lumen depreciation of not more than 30% (L70)
- › T_a of up to **45°C^(*)**
- › **Slim, aesthetical design** optimised for LED characteristics
- › Designed to **replace conventional HID and CFL** bulkhead luminaires
- › **Easy to install**
- › Surge protection **10kV/10kA**
- › 5 year **warranty^(**)**



Painted version



Painted version

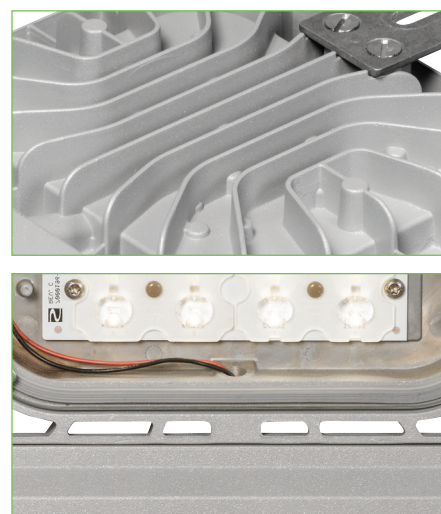

Unique thermal design concept

^(*) Not applicable to all configurations
^(**) Terms and conditions apply

KEY CHARACTERISTICS

	LEDnova-mini	LEDnova-midi
Typical luminaire output flux (range) ^(*)	2,631 to 7,676lm	10,235 to 10,493lm
Power consumption (W) ^(*)	20 to 55W	70 to 81W
Lifetime residual flux @ t _a 25°C		70% @100,000h
Colour temperature	Neutral white (4000K) or warm white (3000K)	
Colour Rendering Index (CRI)		CRI 70
Optical compartment tightness level		IP 66 ^(**)
Control gear tightness level		IP 66 ^(**)
Impact resistance (glass/polycarbonate)	IK 08/10 ^(***)	IK 07/10 ^(***)
Nominal voltage		198-264V – 50 Hz
Electrical class		I or II
Surge protection	10kV	10kV (20kV optional)
MATERIALS		
Body	Marine grade aluminium (EN 1706 AC-44300)	
Protector	Glass or high-impact polycarbonate	
Finish	Unpainted aluminium	

^(*) The initial flux and power consumption of the luminaire are indicative values and valid for 25°C ambient temperature. The real flux output of the luminaire depends on environmental conditions (e.g. temperature) and may vary with specific configurations. Communicated values are subject to tolerances in technology. To check if this document refers to the latest information available, please visit www.beka-schreder.co.za

^(**) according to SANS 60598 – ^(***) according to SANS 62262

DIMENSIONS | WEIGHT

	LEDnova-mini	LEDnova-midi
L1	372mm	406mm
L2	396mm	396mm
L3	460mm	442mm
W	249mm	317mm
H	63mm	73mm
 KG	3.8kg	4.2kg
CIS	0.09m ²	0.13 m ²

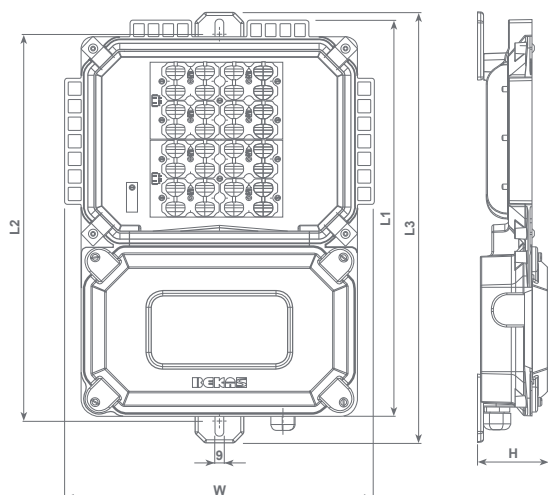

MOUNTING OPTIONS

LEDnova-mini

Wall/Ceiling mounting (standard)

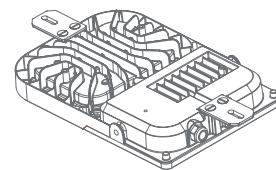

Stirrup mounting (optional)

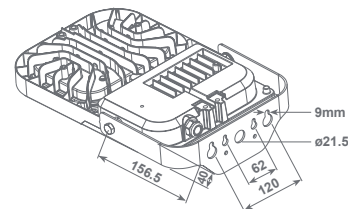

Pole mounting (optional)

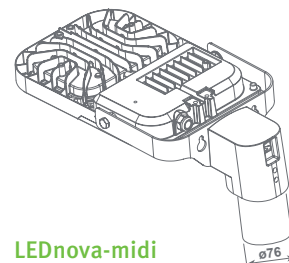

LEDnova-midi

Wall/Ceiling mounting (standard)

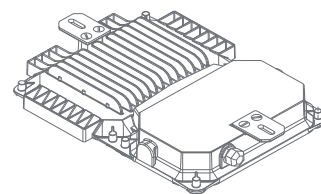

Stirrup mounting (optional)

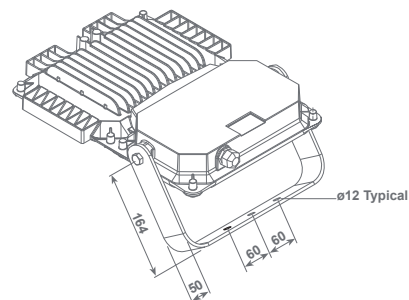

Pole mounting (optional)

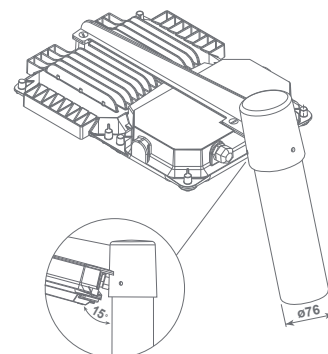

PHOTOMETRY

STANDARD VERSION

OVERVIEW		Mini			Midi		Lifetime residual flux @ T _a 25°C (**)	
Number of LEDs	Neutral white (4000K)	8 LED	16 LED	24 LED	24 LED	32 LED	@60.000h	@100.000h
LED Current: 700mA	Nominal flux (lm)*	2631	5157	7676	-	10235	90%	70%
	Power consumption (W)	20	37	54	-	70		
LED Current: 1000mA	Nominal flux (lm)*	3498	6995	-	10493	-	90%	70%
	Power consumption (W)	29	55	-	81	-		

ECO VERSION

OVERVIEW		Eco	Lifetime residual flux @ T _a 25°C (**)
Number of LEDs	Neutral white (4000K)	32 LED	@60.000h
LED Current: 700mA	Nominal flux (lm)*	4460	70%
	Power consumption (W)	39	

(*) The nominal flux is an indicative LED flux @ T_a 25°C based on LED manufacturer's data. The real flux output of the luminaire depends on environmental conditions (e.g. temperature and pollution) and the optical efficiency of luminaire.

The type of LED used is subject to change due to the ongoing rapid progress taking place in LED technology.

(**) In accordance with LM-80 – TM-21

Electronic data files can be downloaded from www.beka-schreder.co.za/knowledge-base

LIGHT DISTRIBUTIONS

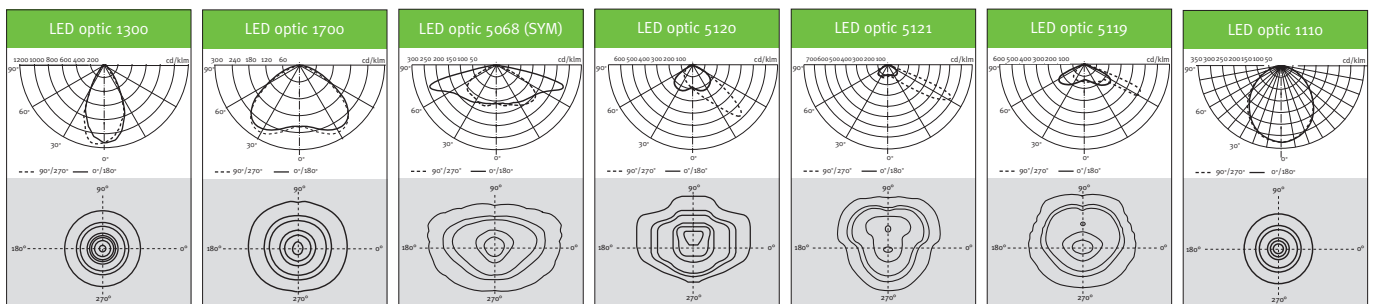

INTEGRATED MOVEMENT SENSOR (OPTIONAL)

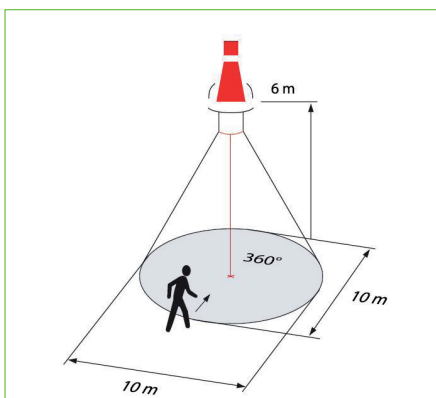

The integrated motion sensor uses a specific lens to determine a detection zone. The standard lens is suitable for most applications. As an option, lenses can be provided for special needs.

ORDERING DATA

DESCRIPTION	LINE CURRENT (A)	LEDs	LED CURRENT (mA)	LUMEN	MASS (KG)
LEDnova-mini 20W	0.09	8	700	2 631	3.8
LEDnova-mini 29W	0.13	8	1000	3 498	3.8
LEDnova-mini 37W	0.16	16	700	5 157	3.8
LEDnova-mini 55W	0.24	16	1000	6 995	3.8
LEDnova-mini 54W	0.24	24	700	7 676	3.8
LEDnova-midi 81W	0.36	24	1000	10 493	4.2
LEDnova-midi 70W	0.31	32	700	10 235	4.2
ECO VERSION					
LEDnova-mini 39W	0.15	32	700	4 460	3.8
EMERGENCY VERSION - 1 HOUR					
LEDnova-midi 37W	0.16	16	700	5 157/745 (EM)	4.4
LEDnova-midi 55W	0.24	16	1000	6 995 /745 (EM)	4.4
LEDnova-midi 81W	0.36	24	1000	10 493 /745 (EM)	4.4
LEDnova-midi 70W	0.31	32	700	10 235 /745 (EM)	4.4

Standard optic: 5068 - symmetrical extra wide
 Standard finish: Unpainted aluminium
 Standard CCT: Neutral white (4000K)

OPTIONS AND ACCESSORIES

ELECTRICAL

Switching/dimming control	Integrated movement sensor/daylight switch (Midi only)
	Controllable stand-alone dimming device
Power supply	Solar version: suitable for 12V or 24V DC power supply
Nominal Voltage	90-305V - 50Hz (Midi only)
Surge protection	20kV/20kA (Midi only)
Correlated colour temperature	Warm white (3000K)

MECHANICAL

Mounting	Pole mount casting
	Stirrup mount
Protector	Frosted glass (Mini only)
	High-impact polycarbonate (IK 10)
Cover	Cover for special applications
Colour	Pearl Light Grey (RAL 9022), Textured finish
	Other RAL colour, Matt finish
	Other RAL colour, Brilliant finish
	Other RAL colour, Textured finish

PHOTOMETRICS

Optics (*)	1100 - narrow spot	1300 - wide spot	5120 - narrow area
	1110 - extra wide low glare (**)	1700 - wide general	5121 - wide area
	1200 - medium spot	5068 - extra wide (sym)	5119 - extra wide area

EXPLOSION PROOF

Classification	Zone 2 (not available for LEDnova-mini and the LEDnova-midi EM 16LED/1000mA version)
	Zone 21/22

(*) Not for Eco version
 (**) Only for Eco version



SAFETY



WELL-BEING



SUSTAINABILITY



SAVINGS



SOLUTIONS

